

Trucks or buses should only be refueled from a dispenser H35

1.
180048
180050
0008600
000

2.
Go to the point-of-sale and proceed following the on-screen instructions. The point-of-sale is on the wall of the building.

3.
Return to the selected dispenser and connect the nozzle to the vehicle valve.

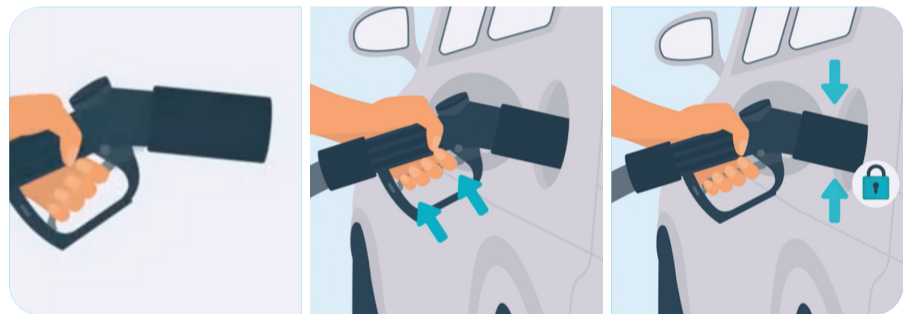

4.
Make sure the nozzle is firmly located on the vehicle valve.

5.
To start refuelling, press the green button on the dispenser.



6.
When the dispenser informs about the end of the refuelling process unlock the nozzle, disconnect from the vehicle and place it on the holder.

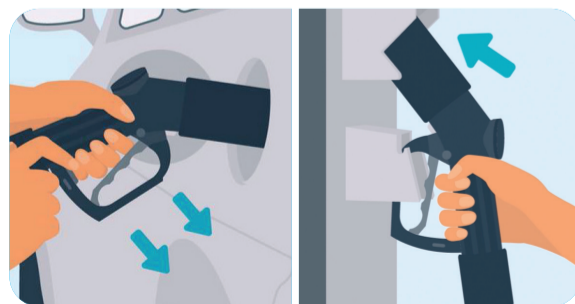

7.
Return to the point-of-sale and collect your receipt or invoice.